

Note that all unique customer requirements (i.e tolerance) need to be verified thru Alfa Laval.

Z80
Alloy 316
S3,S4

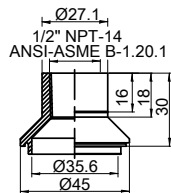

Z 25
Carbon Steel
S1,S2,T3,T4

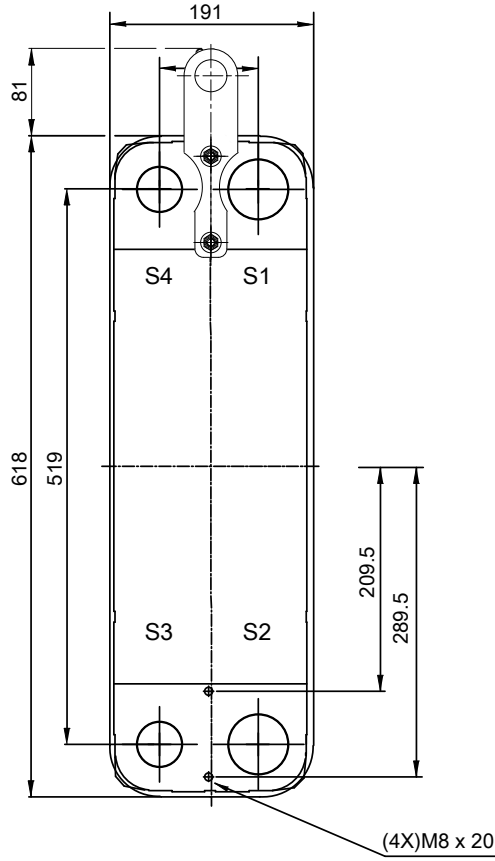
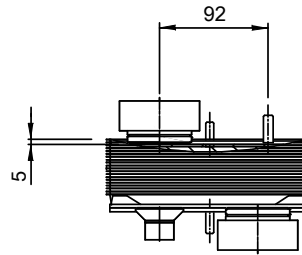
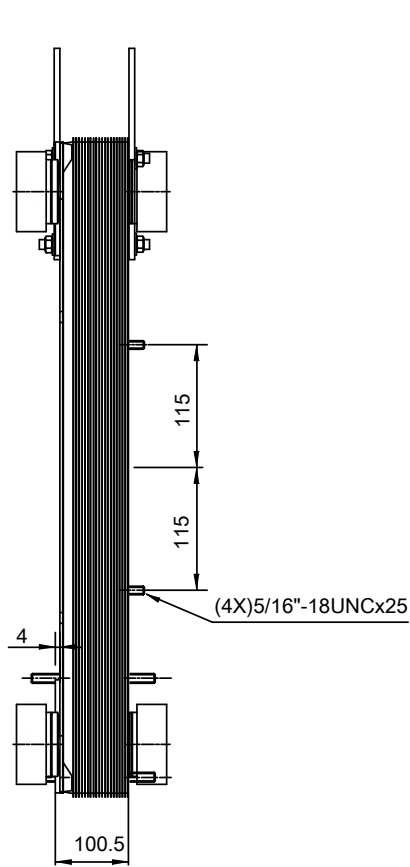
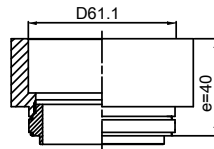

T1 T2 T3 T4 locations on back side correspond to S1 S2 S3 S4 on front side

(4X)M8 x 20

HEATING SURFACE
NETWEIGHT 30.9 kg
OPERATING WEIGHT
PLATE MATERIAL Alloy 316
PLATE GROUPING 1*14H/1*15H

ALL DIMENSIONS IN MILLIMETERS

SIDE	MEDIA	INLET	TEMP.	OUTLET	TEMP.	FLOW RATE	PRESSURE DROP	LIQUID VOL.
1								3.5 dm ³
2								3.75 dm ³

PRESSURE VESSEL APPROVAL

ASME 302 degr F/CRN

AlfaNova HP 76-30H W65 ASME (3287131342)

www.alfalaval.com

CUSTOMER NAME / REF. NO.

TOTAL LENGTH 171.5 mm
TOTAL WIDTH 191.0 mm
TOTAL HEIGHT 699.0 mm

COMPANY / REF.

6/27/2017
REV 0